

## DISASSEMBLY

### 1. REMOVE O/D MAIN SWITCH TERMINAL

- Remove the connector from the shift lever plate.
- Disengage the secondary locking device.
- Release the locking lug of the terminals 5 and 10, and pull the terminals out from the rear.

### 2. REMOVE SHIFT LEVER KNOB SUB-ASSEMBLY

Remove the 2 screws and shift lever knob sub-assembly.

#### NOTICE:

**Pay attention not to apply unnatural load onto O/D main switch wire harness.**

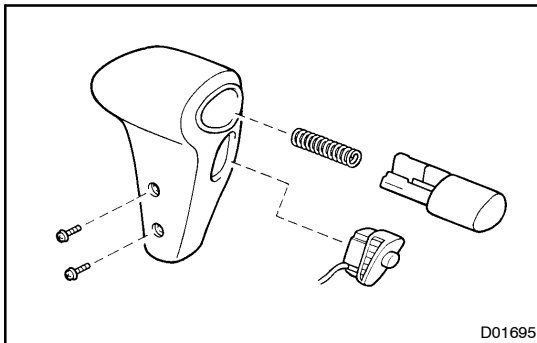

### 3. DISASSEMBLE SHIFT LEVER KNOB SUB-ASSEMBLY

- Remove the shift lever knob and spring.
- Remove the O/D main switch.

### 4. DISCONNECT INDICATOR LIGHT

- Remove the indicator light from indicator housing.
- Remove the cap and bulb from indicator light wire.

### 5. REMOVE INDICATOR HOUSING

Remove the screw and indicator housing.

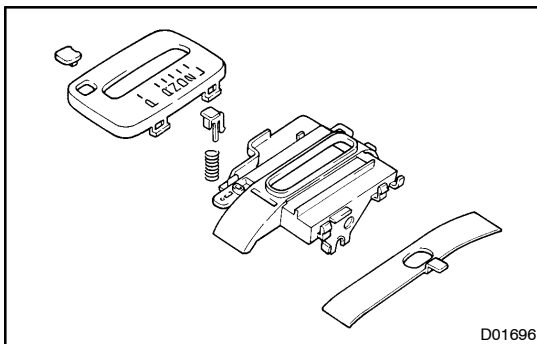

### 6. DISASSEMBLE INDICATOR HOUSING

- Remove the position indicator lower housing, position indicator slide cover and shift lock release button cap from the position indicator upper housing.
- Remove the shift lock release button and spring from the position indicator lower housing.

### 7. REMOVE SHIFT LOCK UNIT

- Disconnect the shift lock solenoid bracket connector.
- Remove the 2 screws and shift lock solenoid bracket.
- Remove the shift lock control ECU.

### 8. REMOVE SHIFT LEVER SUB-ASSEMBLY

- Remove the grommet and No.1 bushing from the shift lever sub-assembly.
- Remove the 3 collars and shift lever boot.

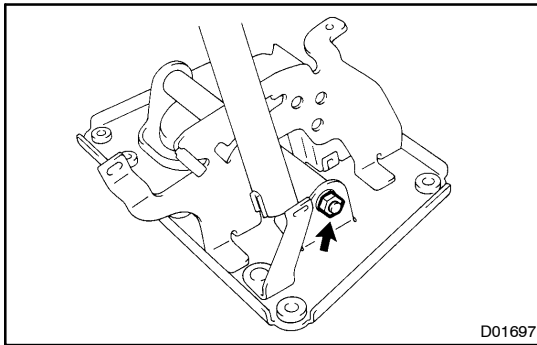

- (c) Remove the nut and control rod.
- (d) Remove the shift lever sub-assembly.

**9. DISASSEMBLE SHIFT LEVER SUB-ASSEMBLY**

- (a) Remove the 2 bushings from shift lever sub-assembly.
- (b) Remove the shift lever knob sleeve and spring from the detent rod.
- (c) Align the grooved pin with the notch of the guide hole.

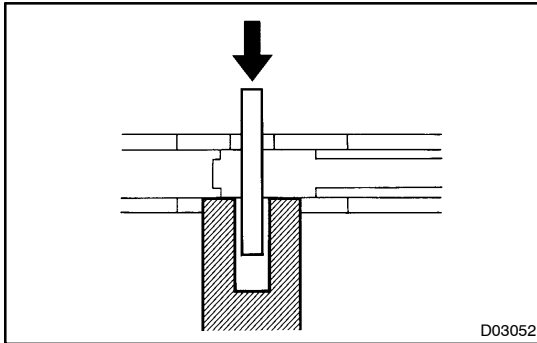

- (d) Using a hammer, remove the grooved pin.

**NOTICE:**

**When pressing in the grooved pin, if doing it at the place other than the notch, there may be fear of damaging the shift lever sub-assembly.**

- (e) Remove the wire guide, wire guide No.2 and detent rod from the shift lever sub-assembly.

**10. REMOVE 3 COLLARS AND 3 BUSHINGS FROM SHIFT LEVER PLATE**

**11. REMOVE SHIFT LEVER STOPPER**